

**Instruction manual (EN)**  
FX-P350 / FX-P355  
HDMI 2.0 Single Fiber Pigtail Extender

**PureLink**  
digital solutions



# HDMI 2.0 Single Fiber Pigtail Extender

## TABLE OF CONTENT

| <b>CHAPTER</b>                         | <b>PAGE</b> |
|--|-------------|
| Introduction .....                     | 3           |
| Intended use .....                     | 3           |
| Safety Instructions .....              | 4-5         |
| Delivery Content .....                 | 6           |
| Features .....                         | 6-7         |
| Application .....                      | 7           |
| Specifications .....                   | 8-9         |
| Audio, Video & Optical .....           | 8           |
| General .....                          | 9           |
| Operation and connection diagram ..... | 10          |
| Troubleshooting / Status LED .....     | 11          |
| Maintenance .....                      | 11          |
| Cleaning .....                         | 12          |
| Warranty and Liability .....           | 13          |
| CE-Conformity .....                    | 14          |
| Disposal of the Device .....           | 14          |
| FCC-Compliance Statement .....         | 15-16       |
| Disclaimer .....                       | 17          |

## INTRODUCTION

Thank you for purchasing the FX-P350 / FX-P355.

This product is a HDMI 2.0 Single Fiber Pigtail Extender pair.

With the optical extender, you are instantly able to stream 4K content over a single fiber optic cable to TVs up to 1000m away. The dongle includes all hardware and firmware needed to support full-rate 18 Gbps HDMI signals, as well as HDCP content protection.

## INTENDED USE

This product is intended for indoor use only. Do not use it outdoors. Contact with moisture, e.g. in bathrooms, must be avoided under all circumstances.

For safety and approval purposes (CE), you must not rebuild and/or modify this product. If you use the product for purposes other than those described above, the product may be damaged. In addition, improper use can cause hazards such as short circuiting, fire, electric shock etc.

Read the instructions carefully and keep them. Make this product available to third parties only together with its operating instructions.

## SAFETY INSTRUCTIONS

Read the operating instructions carefully and especially observe the safety information before using the device.

If you do not follow the safety instructions and information on proper handling in this manual, we assume no liability for any resulting personal injury or damage to property. Such cases will invalidate the warranty/ guarantee.

**CAUTION:** Use of controls or adjustments or performance of procedures other than those specified herein may result in hazardous radiation exposure.

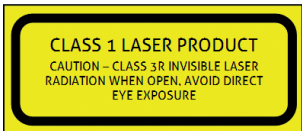

The device is not a toy. Keep it out of the reach of children and pets. Do not leave packaging material lying around carelessly. These may become dangerous playing material for children. Risk of suffocation!

Pay attention to trip hazards; make sure that the cable is installed safely.

Protect the product from extreme temperatures, direct sunlight, strong jolts, high humidity, moisture, flammable gases, vapors and solvents.

Do not place the product under any mechanical stress.

If it is no longer possible to operate the product safely, take it out of operation and protect it from any accidental use.

Safe operation can no longer be guaranteed if the product:

- is visibly damaged
- is no longer working properly
- has been stored for an extended period in poor ambient conditions, or
- has been subjected to any serious transport-related stresses.

Please handle the product carefully. Jolts, impacts or a fall even from a low height can damage the product.

Also observe the safety and operating instructions of any other devices which are connected to the product.

Consult an expert when in doubt about the operation, safety or connection of the device.

## DELIVERY CONTENT

- 1x** HDMI 2.0 Single Fiber Pigtail Sender (TX)
- 1x** HDMI 2.0 Single Fiber Pigtail Empfänger (RX)
- 2x** USB Cable
- 1x** User Manual DE/EN



**1x** User Manual  
DE/EN



**2x** HDMI 2.0 Single Fiber  
Pigtail Extender  
(1x TX, 1x RX)



**2x** USB Cable

## FEATURES

This HDMI 2.0 Single Fiber Pigtail Extender has many features that enable it to perform in a superior manner. Amongst those features you will find:

- Single optical fiber transmission at full 18 Gbps bandwidth
- Resolutions up to 4K@60Hz 4:4:4 incl. HDR 10, HDR 12 and Dolby Vision
- HDMI 2.0, HDMI 1.x and DVI 1.0 compliant
- HDCP 2.2, HDCP 1.4 compliant
- Supports CEC and transparent EDID
- Zero frame delay, no latency, no compression

- Single MultiMode fiber cable to up to 1000m - SC connector
- Supports all HDMI audio formats incl. Dolby TrueHD and DTS-HD Master Audio
- Easy Plug & Play installation
- Status LED for simple trouble shooting
- Metal housing for optimized EMI protection and cooling
- Secure Lock HDMI Connector / Ultra Lock HDMI Connector

## APPLICATION

This product is suitable for the following applications:

- Digital Signage
- LED Signboards
- Home Theater
- Extension of Blu-ray, 3D Video, Projector, Set-top box, DVR, Game Consoles and Computers
- Broadcast
- Conference Room
- Video Equipment
- Security Systems

## SPECIFICATIONS

| Audio, Video & Optical |   |
|------------------------|---|
| TX input               | 1 x HDMI locking male<br>1 x USB (power & firmware)                                 |
| TX output              | 1 x OPTICAL (SC)  |
| RX input               | 1 x OPTICAL (SC)<br>1 x USB (power & firmware)                                      |
| RX output              | 1 x HDMI locking male   |
| HDMI standard          | HDMI2.0, HDCP2.2, HDR 10, HDR 12 and Dolby Vision incl. RGB, YCbCr 4:4:4, CEC, EDID |
| Bandwidth              | 18Gbps (6 Gbps / colour)  |
| Resolution             | Up to 4K / UltraHD / 20160p (4096x2160) @60Hz, 4:4:4                                |
| Supported audio        | Up to Dolby Atmos / DTS HD Master Audio   |
| Transmission mode      | Optical multimode fiber   |
| Laser wavelength       | HSL: 780, 800, 825, 850 nm;<br>LSL: 910, 980 nm                                     |
| Status LED             | Power, video and HDCP status  |



| <b>General</b>                  |  |
|---------------------------------|--|
| Transmission distance           | Up to 1.000 m  |
| Operation / storage Temperature | -0-50°C / -40-85°C   |
| Humidity                        | 10% ~ 90% RH   |
| Power supply                    | TX micro USB 5V1A or HDMI<br>RX micro USB 5V1A                 |
| Power consumption               | TX 1.5 / 2.0 W (max)<br>RX 0.8 / 1.0 W (max)                   |
| Dimensions (W*H*D)              | 362mm x 11.5mm x 30.3mm<br>Housing<br>88.2mm x 11.5mm x 30.3mm |
| Net weight (g)                  | 127g   |
| Certification                   | CE, FCC, REACH, ROHS   |

## OPERATION AND CONNECTION DIAGRAM

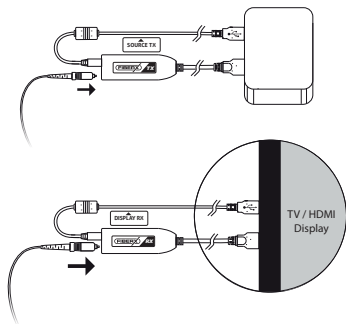







1. Remove Source Converter and Display Converter from box.
2. Plug USB cable into Source Converter.
3. Plug USB cable into Display Converter.
4. Plug both Source HDMI and USB cables into the HDMI video source (See label with Source arrow on back).
5. Plug both Display HDMI and USB cables into the HDMI display (See label with Display arrow on back).
6. Plug one end of the SC Fiber Cable into the Source Converter.
7. Plug the other end of the SC Fiber Cable into the Display Converter. The cable will automatically sync to the source.



It is recommended to power on the devices as the final step.

## TROUBLESHOOTING / STATUS LED

| Cable                 |   | Link Status   |
|-----------------------|---|---|
| Off                   |  | Module end has no power   |
| Red - steady/flashing |  | Module detects open fiber connection and has disabled the lasers  |
| Yellow                |  | Fiber link detected but link initialization failed  |
| Green - flashing      |  | Link functional with no HDCP video  |
| Green - steady        |  | Link functional with HDCP 1.x video   |
| Blue                  |  | Link functional with HDCP 2.x video   |
| Pink                  |  | Module detects open fiber connection and has disabled the lasers and USB is connected and ready for firmware update |

## MAINTENANCE

There are no components located inside the product you need to maintain. Never open/dismantle the product.

Maintenance, modifications and repairs are to be performed exclusively by an expert or at a qualified shop.

If you have questions which remain unanswered by these operating instructions, contact our technical support service or other technical personnel.

## CLEANING

Do not clean the SC connection without using appropriate fiber cleaning equipment such as a One-Click-Cleaner. Using any other type of cleaning product is liable to damage the fiber port beyond repair.

Before cleaning the product it must be disconnected from all other connected products. Ensure the dust cap is always replaced when not connected to an SC cable.

Do not use any aggressive cleaning agents, rubbing alcohol or other chemical solutions as they can cause damage to the housing or cause malfunctions. Be sure not to get cleaning products or solvents in or around the the fiber port, even when the dust cap is in place.

To clean the product, a dry, soft and clean cloth is sufficient. Do not apply too much pressure to the housing as this may cause scratch marks.

You can easily remove dust using a long-haired, soft and clean brush.

## WARRANTY AND LIABILITY

The manufacturer guarantees full statutory warranty terms on all new devices.

As the manufacturer has no influence on installation, warranty only applies to the product itself.

If any fault or damage is detected on your product, please contact your dealer and provide your sales slip or invoice as evidence of the purchase, if necessary. Your dealer will repair the fault either on site, or send the device to the manufacturer. You make the work of our technicians considerably easier, describing possible faults in detail – only then you can be assured that faults, occurring only rarely, will be found and repaired with certainty!

The manufacturer is not liable for damages to persons or property caused by improper installation, operation or maintenance, not described in this manual.

Do not alter or modify the product or its accessories.

Any use other than described in this user`s manual is not permitted and causes loss of warranty, loss of guarantee, and non-liability.

## CE CONFORMITY



PureLink GmbH hereby declares that the FX-P350 / FX-P355 complies with Directive 2014/30/EU.

The full text of the EU Declaration of Conformity is available at the following Internet address:

[www.purelink.de/ce/4251364712146\\_CE.pdf](http://www.purelink.de/ce/4251364712146_CE.pdf)  
[www.purelink.de/ce/4251364712153\\_CE.pdf](http://www.purelink.de/ce/4251364712153_CE.pdf)

## DISPOSAL OF THE DEVICE



WEEE-Reg. No.: DE 93847290

According to the European WEEE directive, any electrical and electronic equipment must not be disposed of along with consumer waste. As a consumer, you are committed by law to deposit electrical and electronic devices at public collecting points or to the dealer for free at the end of the device's lifetime. Details are regulated in the respective national legislations. The Wheelie Bin symbol on the product, in the manual or on the packaging refers to these terms. With the return of your used devices you actively take part in protecting the environment.

## FCC COMPLIANCE STATEMENT

This device complies with part 15 of the FCC rules. Operation is subject to the following two conditions: (1) This device may not cause harmful interference, and (2) this device must accept any interference received, including interference that may cause undesired operation.

**Note:** This equipment has been tested and found to comply with the limits for a Class B digital device, pursuant to part 15 of the FCC Rules. These limits are designed to provide reasonable protection against harmful interference in a residential installation.

This equipment generates, uses, and can radiate radio frequency energy and, if not installed and used in accordance with the instructions, may cause harmful interference to radio communications. However, there is no guarantee that interference will not occur in a particular installation.

If this equipment does cause harmful interference to radio or television reception, which can be determined by turning the equipment off and on, the user is encouraged to try to correct the interference by one or more of the following measures:

- Reorient or relocate the receiving antenna.
- Increase the separation between the equipment and receiver.
- Connect the equipment to an outlet on a circuit different from that to which the receiver is connected.
- Consult the dealer or an experienced radio/TV technician for help.

**Important:** Changes or modifications to this product not authorized by PureLink could void the electromagnetic compatibility (EMC) and wireless compliance and negate your authority to operate the product.

This product has demonstrated EMC compliance under conditions that included the use of compliant peripheral devices and shielded cables between system components. It is important that you use compliant peripheral devices and shielded cables between system components to reduce the possibility of causing interference to radios, television sets, and other electronic devices.

Exposure to radio frequency energy The radiated output power of this device meets the limits of FCC/IC radio frequency exposure limits. This device should be operated with a minimum separation distance of 20 cm (8 inches) between the equipment and a person's body.

Responsible party (contact for FCC matters only):

PureLink GmbH  
Von-Liebig-Straße 10  
48432 Rheine  
Germany



## DISCLAIMER

This product complies with the statutory national and European requirements. All company names and product names are trademarks of their respective owners.

All rights reserved.

We reserve our right for misprints and changes of the device, packing or user`s manual.

HDMI® is a registered trademark of HDMI Licensing L.L.C.

Dolby and the double-D symbol are registered trademarks of Dolby Laboratories.







**PureLink GmbH**

Von-Liebig-Straße 10

48432 Rheine

Deutschland

Tel.: +49 (0) 5971 800 299-0

Fax: +49 (0) 5971 800 299-99

[info@purelink.de](mailto:info@purelink.de)

[www.purelink.de](http://www.purelink.de)