

EXCLUSIVE PARTNERSHIP

PureLink

+

Just Add
@Power

NEW 4K60 VIDEO TILER

imagine
the possibilities

Product Guide
2024 Issue

4K60 Transmitter with Video Tiling & Warping

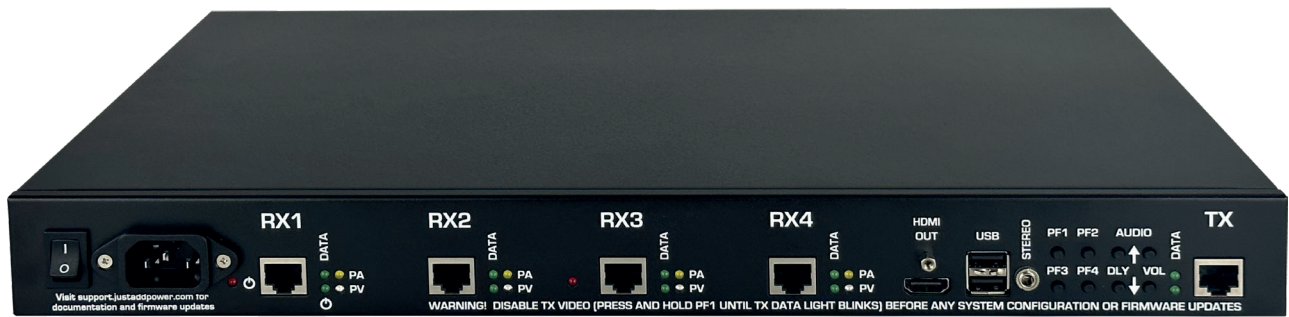

View 4 Sources on 1 Display

The MaxColor 4K60 Video Tiling and Warping Transmitter combines two iconic Just Add Power features into one device:

TILING

Tiling mixes four video sources and combines them into a new, unique, compiled video source that can be viewed by any MaxColor Receiver in the system.

Tile four HDMI sources on a single display in a variety of viewing modes: Quad, Picture-in-Picture, Primary and Secondaries, or any custom layout you can imagine.

Like any standalone Receiver, the four inputs to the MaxColor 4K60 Video Tiling Transmitter can watch any source in the system and the compiled video can be shown on any display in the system.

Multiple video tilers can be combined to add even more sources to a single display.

WARPING

Warping rotates any source in the MaxColor system in 0.1-degree increments in real time and can be viewed by any number of Receivers in the system, allowing for the creation of massive artistic video walls.



Features

Combine Video	Show up to four unique sources on any Receiver in the system	mJPEG Stream	Preview video from any source or display, in any web browser or control system, at up to 30 fps
Combine Tilers	Combine two or more Tilers together to surpass the four-tile limit. There is no limit to the number of Tilers that can combine; two Tilers can show up to 7 sources. Continue this pattern to add 3 video sources for each tiler.	HDMI	Local HDMI Out
Custom Layouts	Create and build custom layout sizing and placement	Scalability	Fully compatible with all MaxColor products
		KVM Control	Manage layouts through USB mouse or API

4K60 Transmitters System Wide Features

- Encodes computer and video resolution up to and including 4K60 @ 4:4:4
- Supports all lossless audio formats
- Supports deep color up to 36-bit
- HDR Support: HDR10, HDR10+, HLG, Dolby Vision, and SDR
- Endpoint Control: CEC, RS232, and IR
- Image Pull
- mJPEG Stream
- Zero detectable latency
- POE Powered
- Seamless Switching

MC-TX1 4K60 Standard Transmitter



- MaxColor System Wide Features

MC-TX2 4K60 Transmitter USB-C w/ optional SFP, ARC & HDMIout



- MaxColor System Wide Features
- Fiber Port Option
- KVM Support
- Audio Return Channel (ARC)

MC-TX3 4K60 Transmitter w/ AES67 & USB-C



- MaxColor System Wide Features
- AES67 RTP Enabled
- 8-Channel LPCM Audio
- HDMI Loopout
- KVM Support

4K60 Receivers System Wide Features

- Decodes computer and video resolution up to and including 4K60 @ 4:4:4
- Supports all lossless audio formats
- Supports deep color up to 36-bit
- HDR Support: HDR10, HDR10+, HLG, Dolby Vision, and SDR
- Endpoint Control: CEC, RS232, and IR
- Image Pull and Push
- mJPEG Stream
- Zero detectable latency
- POE Powered
- Seamless Switching
- Supports Standard Video Wall

MC-RX1 4K60 Standard Receiver



- MaxColor System Wide Features

MC-RX2 4K60 Receiver USB-C w/ optional SFP



- MaxColor System Wide Features
- Fiber Port Option
- KVM Support
- Audio Return Channel (ARC)

MC-QX 4K60 Transmitter w/ Video Tiling & 360° Video Rotation



- Display 4 Sources on 1 Display
- View on Any Screen
- Adjustable Transparency
- Custom Sizing & Placement
- Local HDMI Out
- KVM Control
- Stackable for Unlimited Tiles
- Rotate any HDMI source in 0.1 degree increments
- Real Time Rotation of Video
- Image Push & Pull
- mJPEG Stream

Featured Devices



VBS-HDIP-737POE Warp Engine Transmitter w/ 360° video rotation



- 1 U Rackmount
- Real Time Rotation of Video
- Image Push & Pull
- API or OSD Control of Sources
- Add-on to Any 3G Ultra System



The Warp Engine sends live rotated video to an **unlimited** number of Just Add Power Receivers. Rotate any HDMI source in a Just Add Power matrix in **0.1 degree increments**.

VBS-HDIP-759A Video Tiler Combines 4 sources to single output



- Display 4 Sources on 1 Display
- View on Any Screen
- Adjustable Transparency
- Custom Sizing & Placement
- Mix Any Resolution Source
- Local HDMI Out
- Stackable for Unlimited Tiles
- Smooth Transitions for Live Events



The Video Tiler allows any integrated screen with a Just Add Power Receiver attached to do multiview.

Tile **four (or more) HDMI sources** on a **single display** in a variety of viewing modes.

Now supporting Chroma Key. Get creative with your own special effects using blue/green screen overlay feature.

4K Transmitters System Wide Features

- Encodes 4K or Lower Resolutions
- HDCP 2.2
- 4K/60 Compatible at 4K/30
- HDR Support
- Seamless Switching
- Integrated Endpoint Control
- Zero Detectable Latency
- EDID Management
- POE Powered (unless otherwise noted)
- Plug-Play-Present
- Image Pull
- All 3D Formats Supported

VBS-HDIP-707POE 4K Standard Transmitter

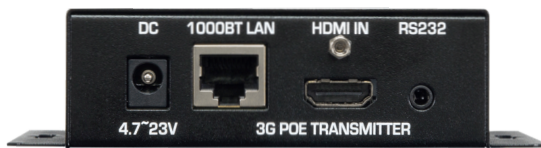

- 4K System Wide Features
- All Lossless Audio Supported

VBS-HDIP-717HIFI 4K Transmitter w/ HDMI loopout



- 4K System Wide Features
- All Lossless Audio Supported
- HDMI Loopout

VBS-HDIP-708POE 4K Transmitter w/ Stereo Audio Extraction



- 4K System Wide Features
- All Lossless Audio Supported
- Stereo Audio Output 3.5mm

VBS-HDIP-718AVP 4K Transmitter w/ Dolby DSP, USB & Stereo out, Mic- & Line-in



- 4K System Wide Features
- Stereo and Dolby Digital 5.1 audio formats
- Dolby DSP
- KVM Support
- Stereo Audio Output 3.5mm
- Two Analog Audio Inputs Mixable with HDMI Audio

VBS-HDIP-709 4K Point-To-Point Transmitter w/ POE injector

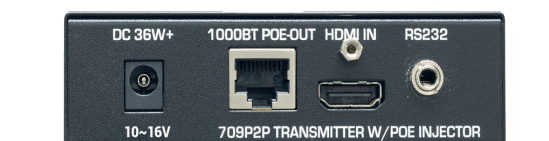

- 4K System Wide Features
- All Lossless Audio Supported
- Built-in POE Injector up to 40W
- Specifically Built for Point-to-Point

VBS-HDIP-767AES 4K Transmitter w/ AES67 audio (LPCM up to 8CH)



- 4K System Wide Features
- AES67 RTP Enabled
- 8-Channel LPCM Audio
- HDMI Loopout

4K Transmitters System Wide Features

- Encodes 4K or Lower Resolutions
- HDCP 2.2
- 4K/60 Compatible at 4K/30
- HDR Support
- Seamless Switching
- Integrated Endpoint Control
- Zero Detectable Latency
- EDID Management
- POE Powered (unless otherwise noted)
- Plug-Play-Present
- Image Pull
- All 3D Formats Supported

VBS-HDIP-707WP2

4K Wallplate Transmitter



- 4K System Wide Features
- 1.5' Total Depth
- Integrated Endpoint Control - CEC Control
- Colors: Black, White or Custom

VBS-HDIP-717WP2

4K Wallplate Transmitter w/ USB & VGA Ports



- 4K System Wide Features
- HDMI and VGA Input
- All Lossless Audio Supported
- Stereo Audio Input
- KVM Support
- Colors: Black, White or Custom

VBS-HDIP-718WP4

4K Wallplate Transmitter w/ Dolby DSP & HDMI Out



- 4K System Wide Features
- HDMI and VGA Input
- Dolby 5.1 Downmixing
- Audio Mixing
- Stereo Audio Input
- Stereo Audio Output 3.5mm
- KVM Support
- Colors: Black, White or Custom

VBS-HDIP-747POE

4K Rackmount Transmitter (4-in-1 707POE)



- 4K System Wide Features
- 4-in-1 Rackmount of 3G POE TX
- All Lossless Audio Supported
- POE or AC Powered

VBS-HDIP-749AVP

4K Rackmount Transmitter (3-in-1 718AVP)



- 4K System Wide Features
- 3-in-1 Rackmount of 3G+ KVM TX
- Supports 110V to 240V AC Power
- Audio Mixing
- Field-Modifiable Dolby Chip Upgrade to Audio/Video Professional (AVP) Model

4K Receivers

System Wide Features

- Resolution Output Scaling
- HDR Support
- HDCP 2.2
- All Lossless Audio Supported
- Integrated Video Scaler
- Seamless Switching
- Integrated Endpoint Control
- Video Wall with Rotation
- EDID Management
- POE Powered (unless otherwise noted)
- Plug-Play-Present Built-in
- Image Push, Pull, Pop
- On Screen Display
- All 3D Formats Supported

VBS-HDIP-508POE

4K Standard Receiver

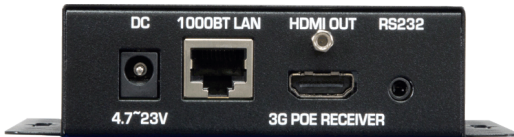

- 4K System Wide Features

VBS-HDIP-518AVP

4K Receiver w/
USB and Stereo Audio Out



- 4K System Wide Features
- Analog Audio Out
- KVM Support

VBS-HDIP-509POE

4K Daisy-Chain Receiver w/
added POE Network Out

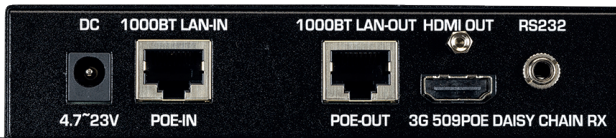

- 4K System Wide Features
- Network Out Port
- Can use with 709P2P for Video Walls
- DHCP Integration
- Supports Multiple Receivers on Single LAN Port

VBS-HDIP-ST1

Stereo Transceiver
Injects or Extracts Stereo Audio



- Stereo audio; 192kHz and 24-bit supported
- Variable audio
- Power Over Ethernet (POE)
- RS232 or IR* control of endpoints
- Transceiver - operates as a Transmitter or Receiver
- As an Transmitter, input stereo audio to play on any Receiver
- As a Receiver, output stereo audio from any Transmitter to a speaker or amp

1080p Transmitters System Wide Features

- Encodes 1080p or Lower Resolutions
- HDCP 1.x
- HDR Support
- Seamless Switching
- Zero Detectable Latency
- EDID Management
- POE Powered (unless otherwise noted)
- Plug-Play-Present
- Image Pull
- All 3D Formats Supported

VBS-HDIP-705POE 1080p Standard Transmitter

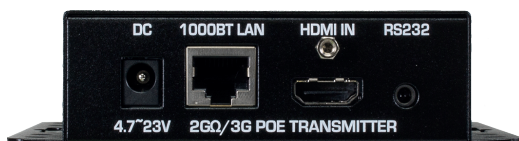

- 1080p System Wide Features
- All Lossless Audio Supported
- Integrated Endpoint Control

VBS-HDIP-725POE 1080p Transmitter w/ SDI in, Stereo & HDMI Out



- 1080p System Wide Features
- Supports 48kHz Audio Sample Rate, 8 Channels, 16~24 Bits
- HDMI Loopout
- Analog Audio Output
- Integrated Endpoint Control - RS232 & IR

VBS-HDIP-715POE 1080p Transmitter w/ USB, Stereo Port & HDMI Out



- 1080p System Wide Features
- All Lossless Audio Supported
- Analog Audio Output
- HDMI Loopout
- Integrated Endpoint Control
- KVM Support

VBS-HDIP-726TVI 1080p Transmitter w/ TVI in, USB & HDMI Out



- 1080p System Wide Features
- TVI Input
- Analog Audio Input
- HDMI Loopout
- KVM Support

1080p Receivers System Wide Features

- 1080p & Lower Resolution Support
- HDCP 1.x
- Integrated Video Scaler
- Video Wall with Rotation
- Seamless Switching
- Integrated Endpoint Control
- All Lossless Audio Supported
- POE Powered (unless otherwise noted)
- Plug-Play-Present
- Image Push, Pull, Pop
- On Screen Display
- All 3D Formats Supported

VBS-HDIP-505POE 1080p Standard Receiver

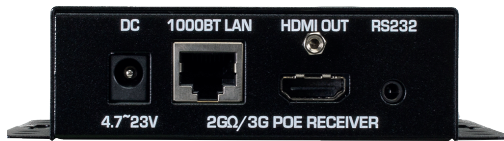

- 1080p System Wide Features

VBS-HDIP-515POE 1080p Receiver w/ USB and Stereo Audio Out

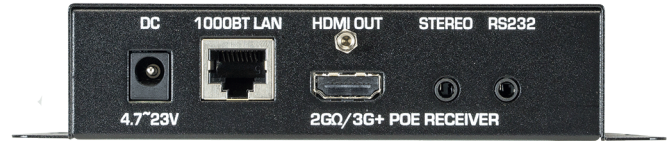

- 1080p System Wide Features
- Analog Audio Output
- KVM Support

IR Control & Rackmount Shelf

VBS-HDIP-IRD2 Converts RS232 Port to IR Emitter



- Serial to IR
- Compatible with All Devices
- Adds IP to IR Control

VBS-HDIP-RS 1U Razor Shelf

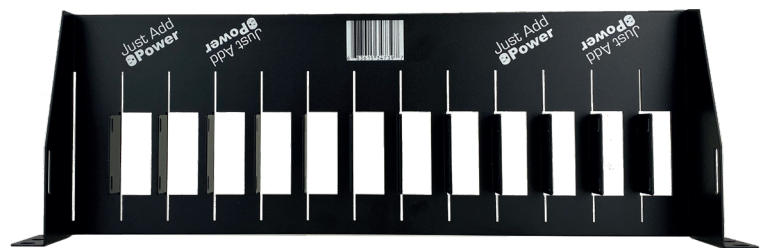

- Compatible with 2G Omega, 3G Ultra, and Maxcolor Devices
- Holds up to 13 Devices
- Max 5U High
- 19' Rackmount Shelf

System Features

Any Size Matrix

Create a flexible matrix of sources and displays limited only by the switch(es) used.

Artistic Video Wall Capability

Send image-rotated video content to a set of displays of any size, mounted at any angle, and pressed edge to edge or spaced apart, to provide a cohesive artistic image with video content chosen or designed exclusively for the layout.

Audio Mixing

Mix analog audio inputs and outputs with digital audio inputs and outputs, including HDMI, AES67 and Dante 8-channel, with adjustable volume, mute and delay.

Chroma Key

Get creative with your own special effects using blue/green screen overlay feature.

DHCP Integration

Provide internet connectivity to a smart device through the same CATx cable that connects the Just Add Power matrix to that device using a DHCP server integrated receiver.

Dolby 5.1 Downmixing

Convert a source's Dolby 5.1 audio to Dolby ProLogic II audio for stereo-only speaker zones and allow both audio formats to be used simultaneously in multiple speaker zones.

Easily Accessible API

Write custom drivers and programs to interact with Just Add Power devices.

EDID Management

Display High Dynamic Range (HDR) content on HDR displays, permit the same content to display on standard screens, and allow content to be displayed simultaneously on both types of screens.

HDCP Support

Display content with HDCP copy/content protection on any HDMI screen in your system.

HDR Support

Support High Dynamic Range (HDR) formats including HDR10, HDR10+, HLG, and Dolby Vision.

Integrated Endpoint Control

Control source and screen devices using built-in Consumer Electronic Control (CEC), Transmission Control Protocol (TCP/IP), Infrared control (IR) or Serial control (RS232).

Image Pop

Display a custom logo or message as an overlay on any active screen.

Image Push

Load a custom default image or logo for when no source is displayed onscreen.

Image Pull

Preview an image from any source or display in any web browser or control system - up to 10 fps.

Image Rotation

Rotate video input in 0.1 degree increments to create artistic video walls with screens at any angle and in any configuration.

KVM Support

Provide local and remote access to all computers on the system with a built-in keyboard, mouse and touchscreen interface at both ends of a connection.

Mosaic Video Wall Capability

Send video content to a set of displays mounted in a combination of equal or differently sized screens, mixed in portrait and landscape orientations, and pressed edge to edge or spaced apart, to provide a cohesive image with video content chosen or designed exclusively for the layout.

mJPEG Stream

Preview video from any source or display, in any web browser or control system, at up to 30 fps

Plug-Play-Present

Capture and maintain a preset protocol that is initiated when a source is connected to a designated transmitter to power on desired display(s) and switch to the newly connected source for quick and easy presentation setup, and an ending protocol for when the source is disconnected from the transmitter, with no additional control system necessary. Available only in VLAN systems.

Resolution Scaling

Downscale a source's 4K signal for viewing on a lower resolution screen and upscale a source's lower resolution signal for viewing on a 4K display.

Seamless Switching

Eliminate black screen downtime when switching sources at the same resolution and minimize black screen downtime when switching sources with different resolutions.

Security

Feel confident that any Just Add Power AV over IP system is secure from outside intrusion, since the system is isolated from all data networks and devices are secure and never connected to or accessed via the internet (firmware updates are done locally by system maintenance staff).

Standard Video Wall Capability.

Send video content to a set of 2 to 256 displays of equal sizes, mounted in a grid in either portrait or landscape orientation and pressed edge to edge, to provide a single wall image or a set of smaller video images with the ability to dynamically change the layout as desired.

Video Rotation

Rotate your video by 90 degrees for portrait or landscape display.

Video Tiling

Combine video input from four sources to create a tiled source that can be displayed on a single screen.

Visually Lossless Video

Send original source signals to multiple and various screens with the same outstanding performance at each display.

Zero Detectable Latency

Minimize encode/decode latency over the network so that it is visually undetectable.

Create

A System

1 Control Options

We work with most major control systems so that you can easily integrate the one that will work best for your project.

Supported Control Systems

An AV over IP network of HDMI devices from Just Add Power can be integrated with any third party control system capable of IP control.



2 Product Options

Three product lines with different levels of resolution and HDR support let you choose anything from an economical solution for a sports bar project to a high frame rate, deep color solution for an art museum or luxury home.

Choose the product line that best fits your project's requirements for HDR support and video resolution.

MaxColor™ 4K60

- Supports up to 4K Resolution at 60fps
- Supports HDR, HDR10, HDR10+, HLG and Dolby Vision formats

3G ULTRA

- Supports up to 4K60 Resolution at 4K30 output
- Supports HDR & HDR10 formats
- Most extensive feature set with image rotation and tiling

2G OMEGA

- Supports up to 1080p Resolution
- Supports HDR format

3 Network Options

Our tech support team certifies switches from the highest quality manufacturers so that you can be certain that integration will be effective and performance will be outstanding.

Compatible Switches

A Layer 3 Gigabit Managed Ethernet Switch is best for video matrixing. We have tested and certified a variety of models from different manufacturers, so you have options to match the size and requirements of your system. Our configuration software will set up your switch, or, if necessary, you can configure your own.



Tested & Certified Switches



Building

A System

Building a System is simple

1 Connect the Transmitters

One **Transmitter (TX)** per source.

Each source in your system will be connected by HDMI cable to a transmitter. The transmitter will encode the source content and send it through your network to the layer three ethernet switch.

2 Connect the Receivers

One **Receiver (RX)** per display.

Next, receivers are connected to each display using HDMI cable. The receivers accept the encoded content routed to them from the switch and decode it for the display to play at the correct resolution and HDR settings.

3 Gigabit Switch

A gigabit switch is used to direct the source content to the intended displays. Just Add Power works with high quality switch manufacturers to ensure interoperability.

Multiple switches may be used to expand the number of sources and displays in your system. Just Add Power devices are connected to the switch using Cat5 or higher cable. Fiber cable is supported in the MaxColor product line.

4 Control System

With our supported control systems, you can trust that you are getting the best possible technology and support for your AV over IP needs. We provide free drivers for popular control systems and an easily accessible API.

5 Configuration

Our configuration software, Advanced Matrix Programmer (AMP) takes you step by step through the process of configuring your Just Add Power devices.

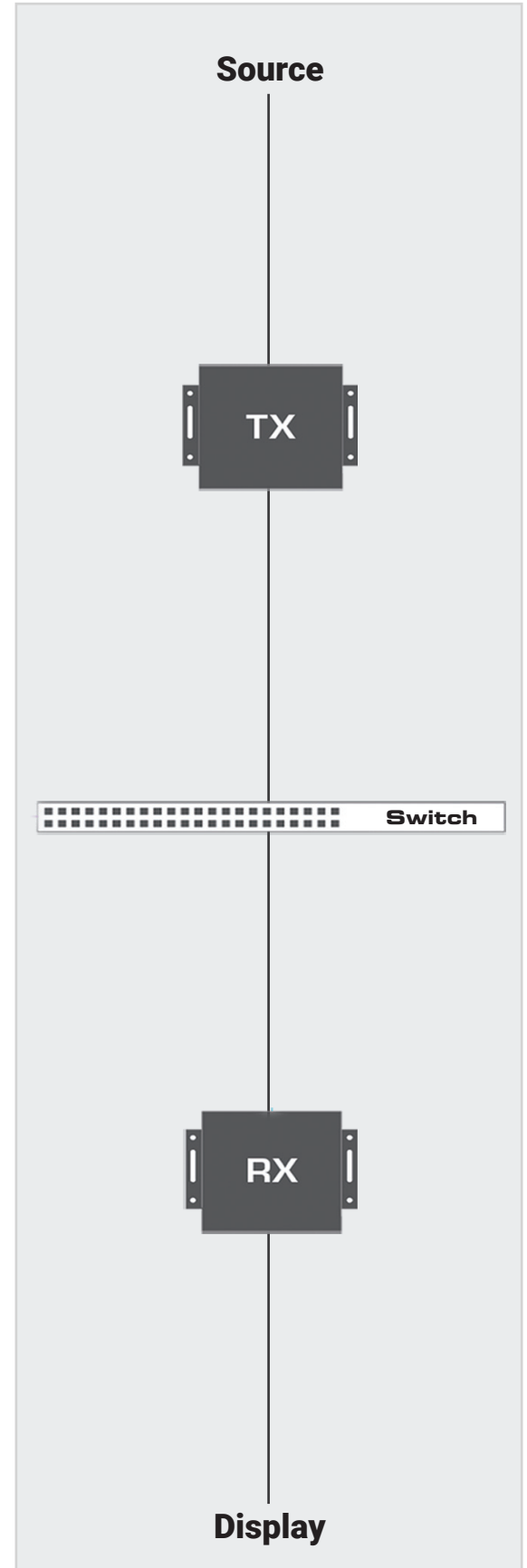

Expanding A System

Compatibility

Just Add Power's 2G Omega and 3G Ultra product lines are compatible and can be integrated interchangeably into your AV distribution system. MaxColor products are not directly compatible, but can be integrated into your system and on your switch using a closed loop or through bridging, which requires additional devices.

Firmware Updates

Just Add Power offers regular firmware updates to keep your devices running optimally and provide you with additional features when innovation breaks. These updates are only installed when you initiate them and are never pushed to the devices.

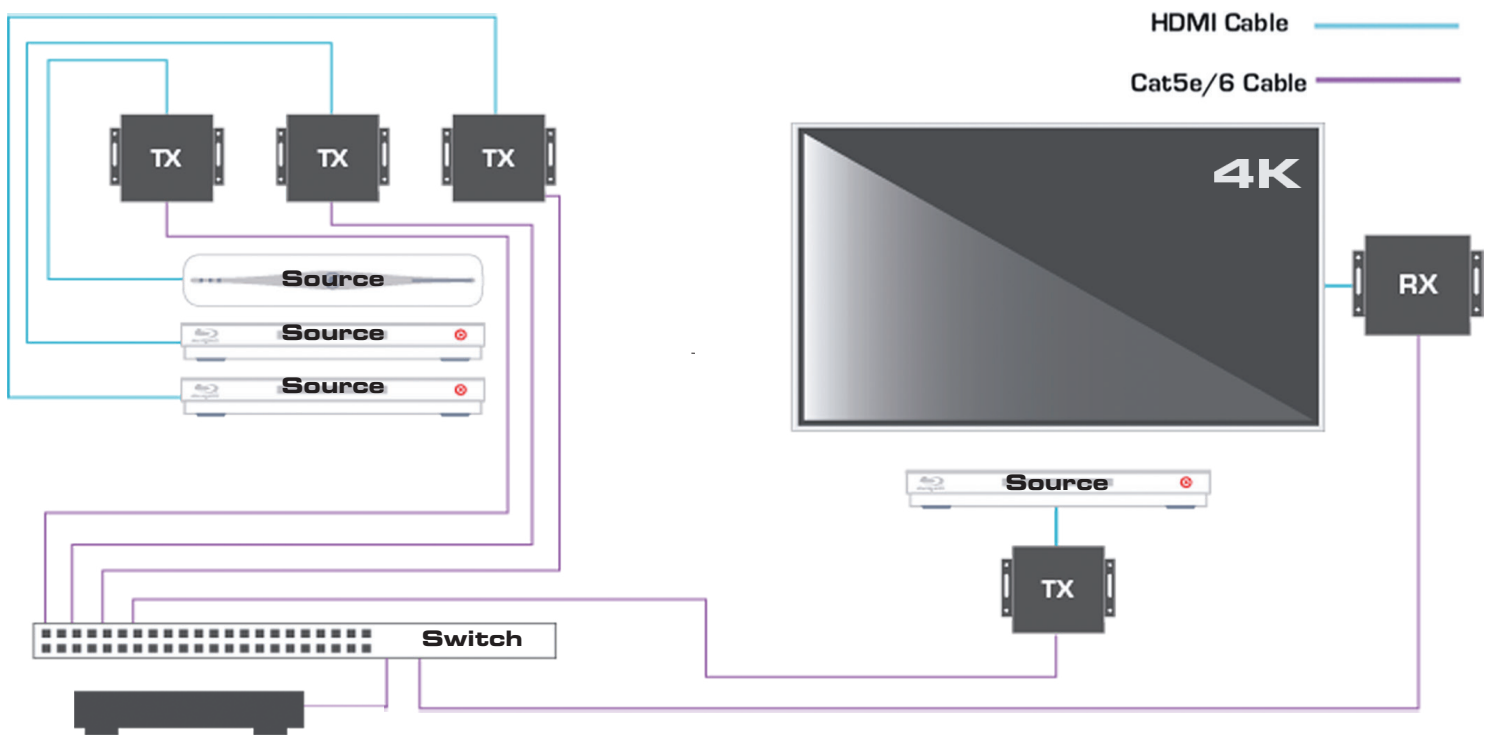

Adding Two New Displays

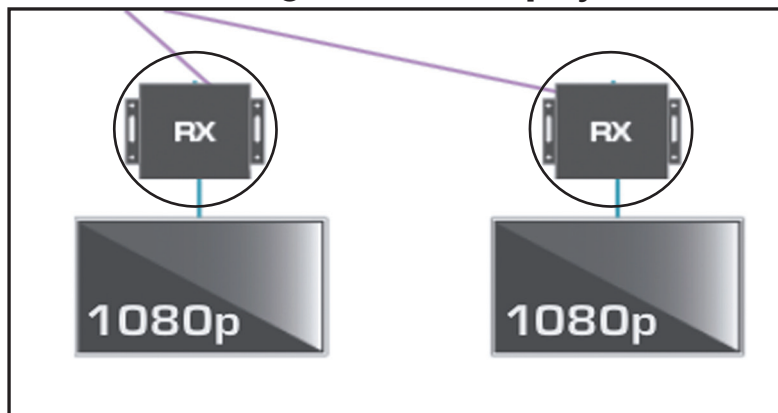

Adding Two New Displays

Expanding a system with two new displays would only require adding two new Receivers.

System

Examples

Residential Install 3 Sources x 5 Displays

4 Bedroom Residential Install: Second Floor

3 Sources x 5 Displays

A simple two story install with a switch located upstairs in the living room closet with 3 sources and 1 display per room (5 total displays).

Residential AV over IP

With Just Add Power, residential installers benefit from having no fixed number of inputs/sources or outputs/displays to work around, have no difficulty distributing to distances over 100m in large luxury homes, and like the fact that they can easily return to a site in the future to expand the system when desired.

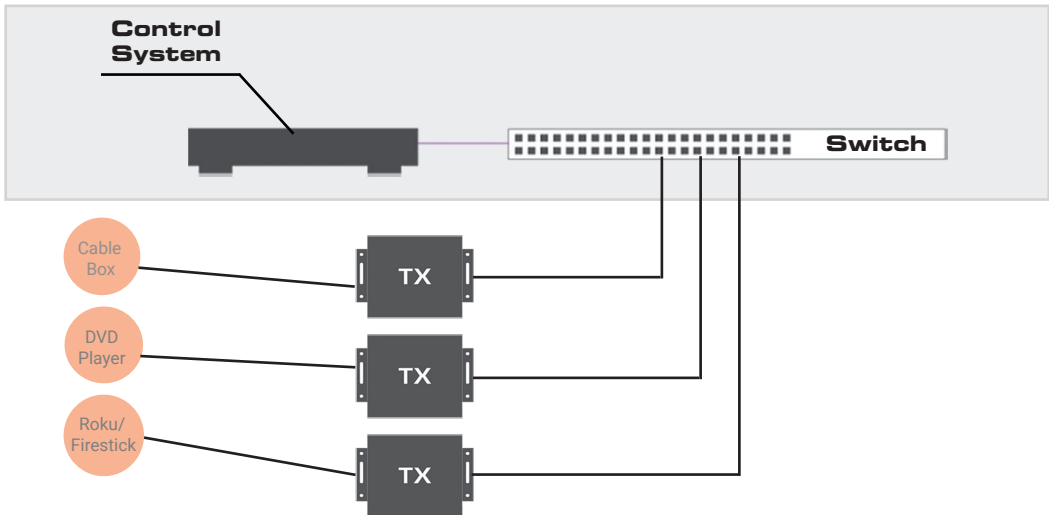
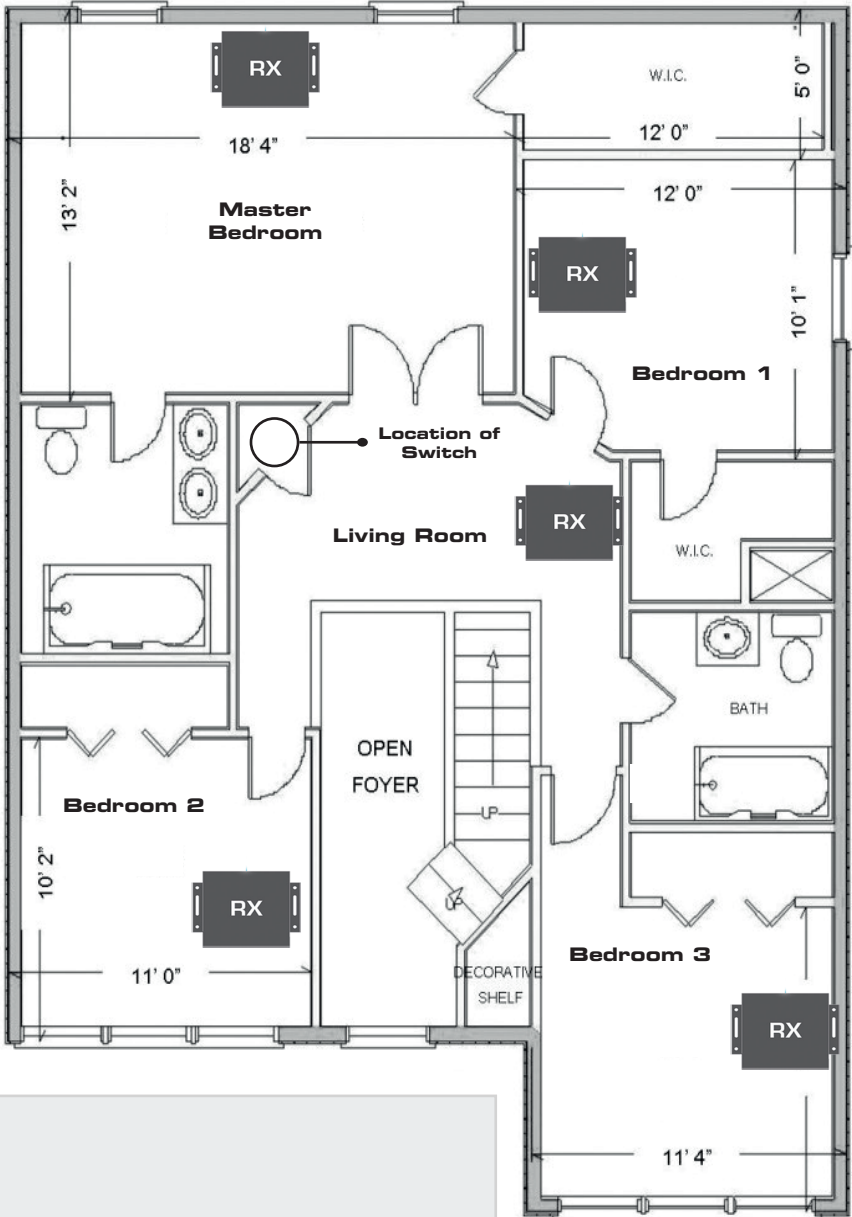

System

Examples

Commercial Install 20 Sources x 30 Displays

Nightclub & Sports Bar Install:

20 Sources x 30 Displays

This install is a perfect example where an installer has used stacked switches to distribute AV throughout this large commercial space.

Paired with a compatible control system, the client and their employees easily manage the sources and screens from anywhere in the building.

Pro AV & Commercial AV over IP

Whether it's an airport, office building, a sports bar or a stadium, Just Add Power lets you build a video distribution system of networked AV devices that is scalable, reliable, economical, and easily controllable.

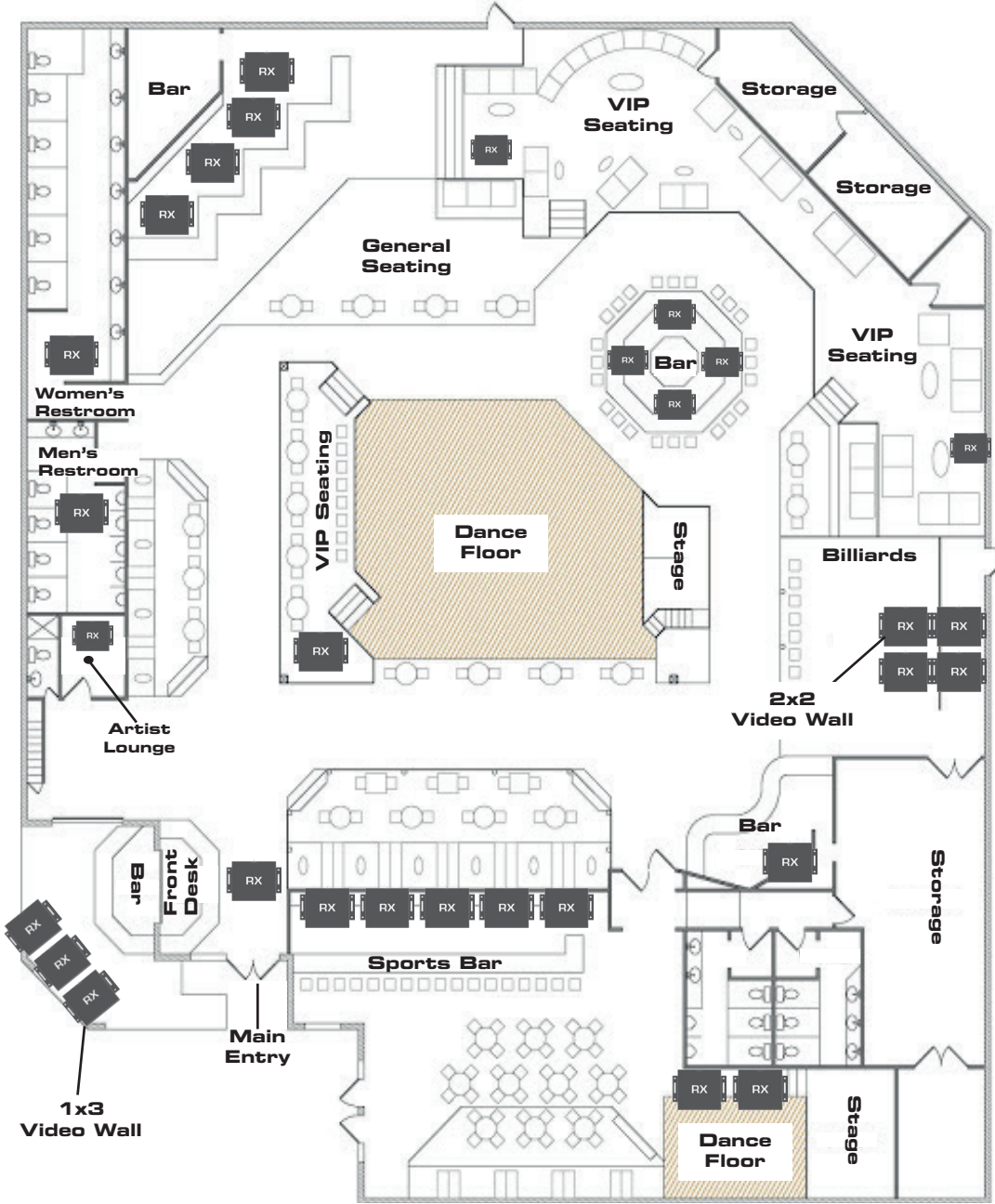

Our AV over IP products can also create stunning standard mosaic and artistic video walls and combine multiple video feeds onto a single screen. Read more about our Warp Engine Transmitter and the Video Tiling Processor on page 2.

Commercial - Entertainment Center

EVO Entertainment Multiplex
 Location: Schertz, Texas
 Integrator: Mood Texas

EVO Entertainment had a vision to pack their 73,000-square-foot facility with nearly a 100 displays consisting of video walls, outdoor displays, signage and more. Integrator Mood Texas was called upon to complete their vision of a high-tech establishment with flawless audio and video distribution. Thanks to Just Add Power's easy installation, seamless switching, video wall functionality, and other features, EVO Entertainment's high-tech vision was turned into a reality.



Residential - Home Theater

The Holladay Cinema
 Location: Salt Lake City, Utah
 Integrator: Tym LLC

This ultimate entertainment space features a custom-built 16-foot wide-screen to display stunning images, a custom Tym signature star ceiling, a Just Add Power video distribution system, and more.



Commercial - Golf Club

Montecito Club
 Location: Santa Barbara, CA
 Integrator: Central Coast Audio Visual

"The owner and members of the Montecito Club have been very pleased with the clean look of the displays in the space, and how simple it is to control them... And it has delivered the performance and reliability the Club expects. The system has performed flawlessly since its deployment and its scalability will allow us to easily meet future growth, whether it's more displays or additional sources."

Chris Wilson
 President of Central Coast Audio Visual



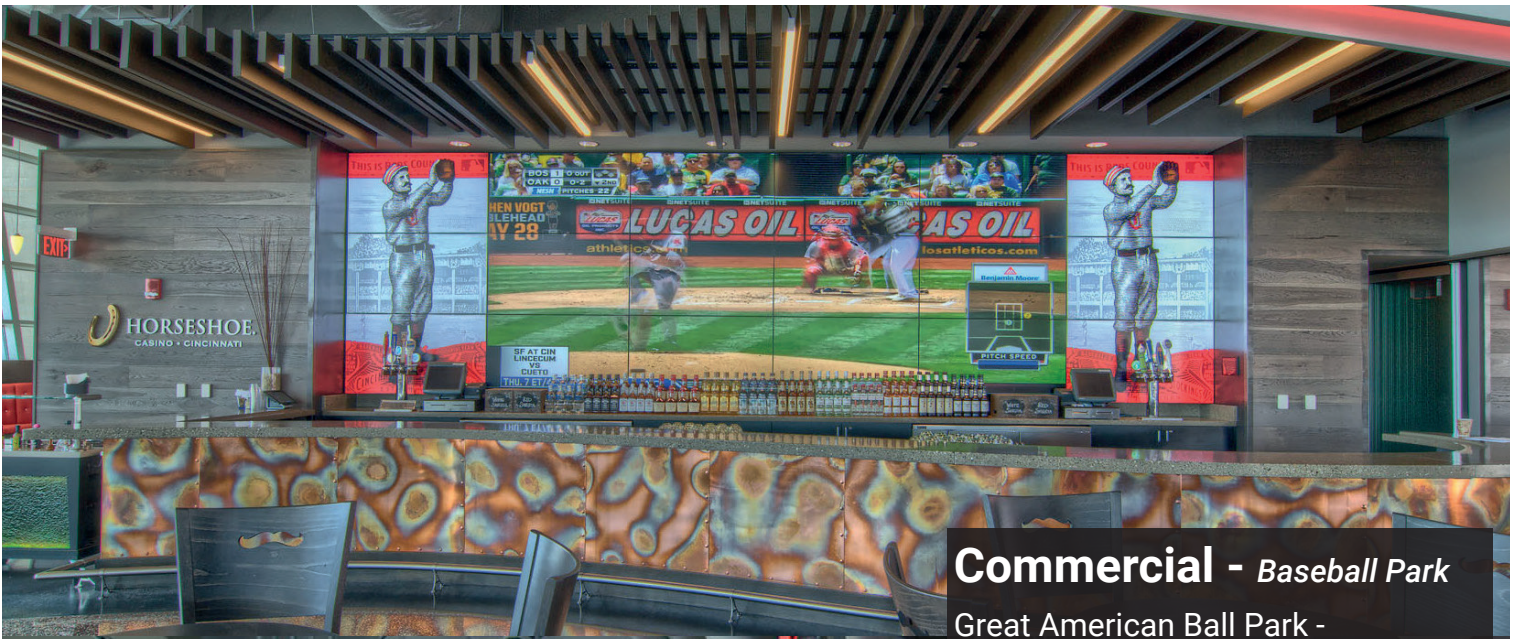

Commercial - Baseball Park

Great American Ball Park -
The Cincinnati Reds Stadium

Location: Cincinnati, OH

Integrator: Nor-Com

"The sports industry is currently faced with the challenge of how to affordably upgrade their technology to provide a seamless, cost-effective, and future-proof entertainment experience for the fans. J+P helps easily solve modern distribution challenges by providing modular system that can be scaled as needed," Synder said. "For the Reds', it's offered incredible versatility that was essential to their vision. We were able to put in new bar or install guest experience as their vision evolved, drop in 60 displays, and send protected HD content to any one of those displays – with a snap of a finger."

Gary Snyder
Senior Programmer at Nor-Com





PureLink





Just Add **@Power**

Contact:

PureLink GmbH
Von-Liebig-Str. 10
48432 Rheine
Germany



 +49 5971 800 299-0
 +49 5971 800 299-99
 info@purelink.de

www.purelink.de

